

### Montage option A

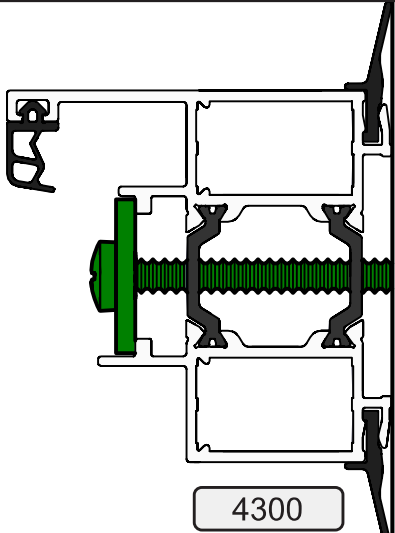

Montage im lichten Maß

### Montage option B

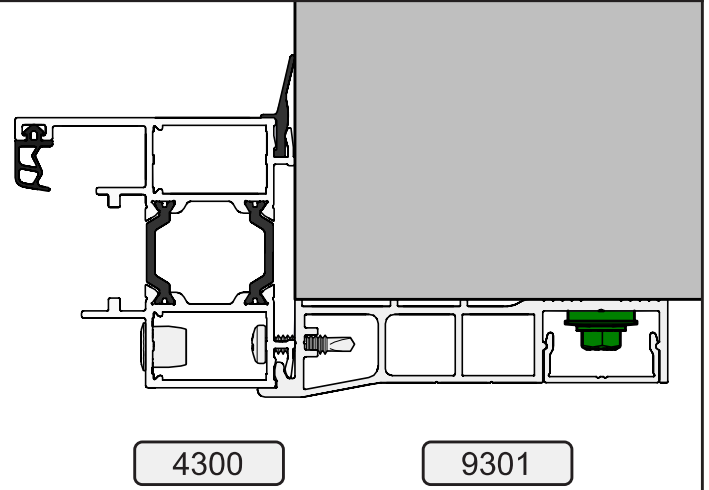

Montage im lichten Maß mit Montageprofil breit

### Montage option C

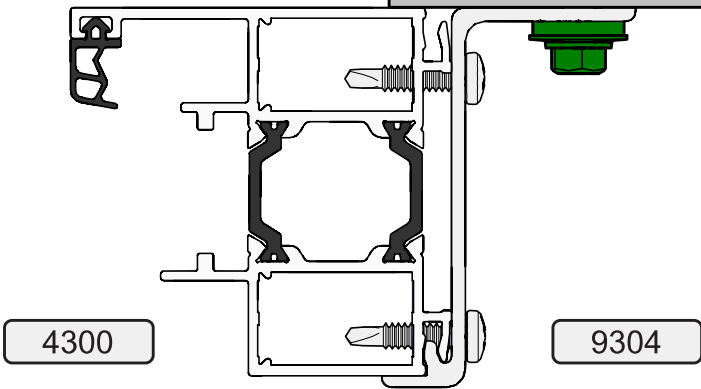

Montage hinter dem lichten Maß mit Montageprofil schmal

### Montage option D

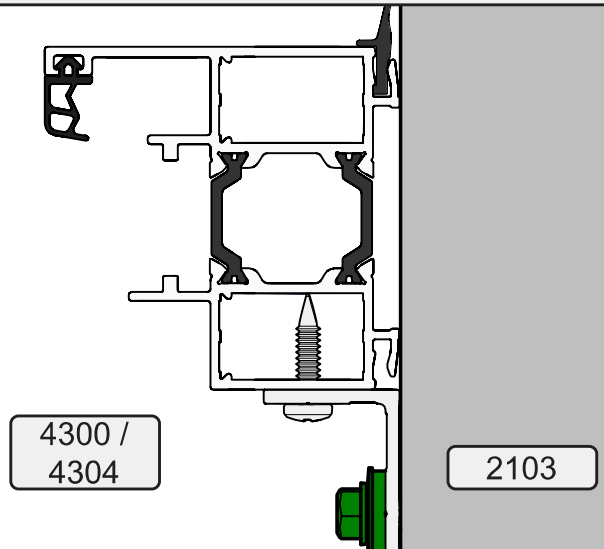

Montage im lichten Maß mit Montageprofil schmal

### Montage option E

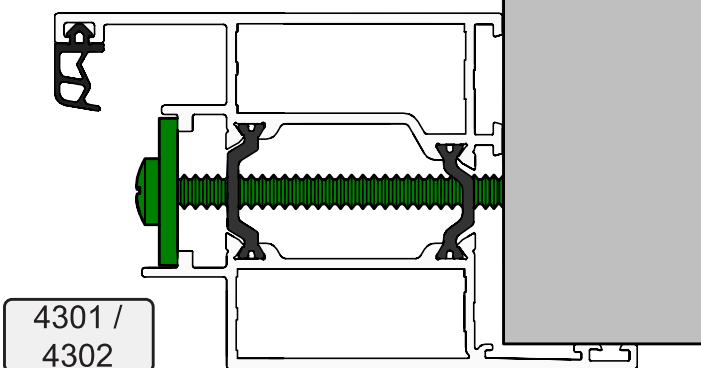

Montage im lichten Maß mit Abdeckleiste innen

### Montage option F

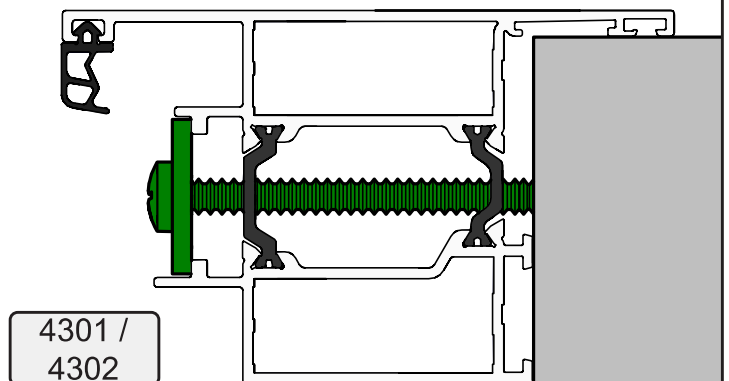

Montage im lichten Maß mit Abdeckleiste außen

4

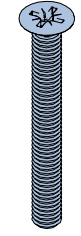
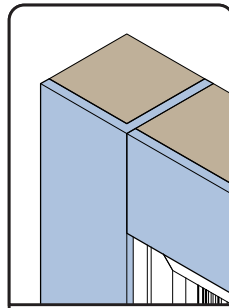
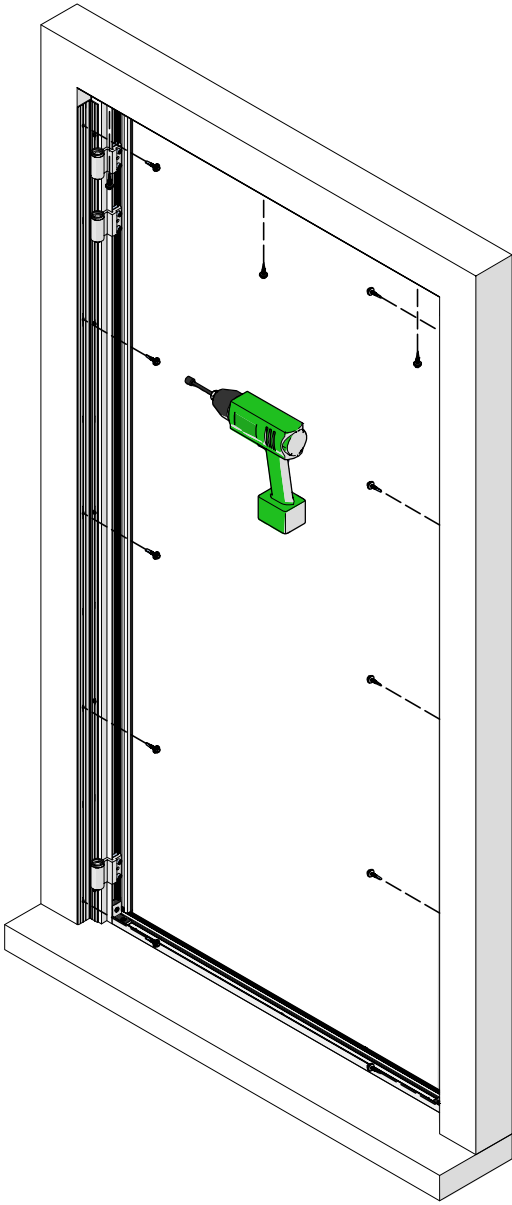

8363

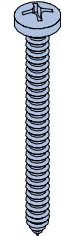
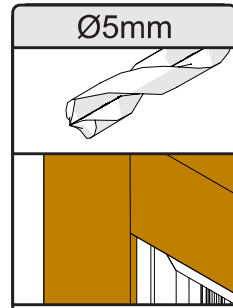

8362

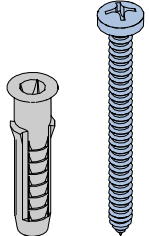
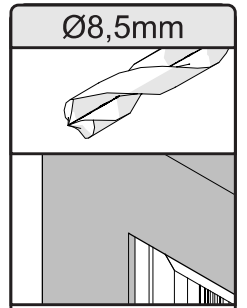

8096 + 8362

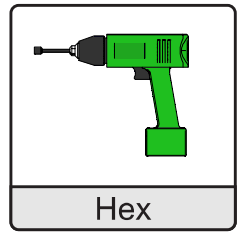

Hex

# Schwelle Montage

